

SPECIFICATION

Current Rating:1A AC/DC
 Voltage Rating:250V AC/DC
 Withstanding Voltage:500V AC/Minute
 Contact Resistance:20 Milliohms Max.
 Insulation Resistance:1000 Megaohms Min.
 Temperature Range:-40°C~+105°C
 Housing:PBT+G.F.(UL94V-0),Black
 Contact:Brass,Selective Gold Plated Over Nickel
 RoHS Compliant

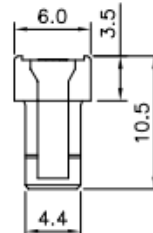

6P
Single Slot

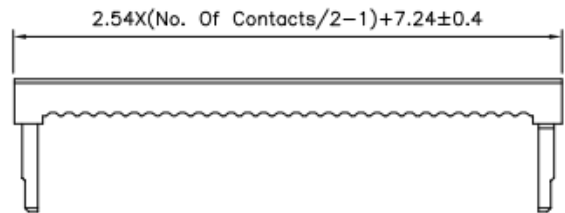
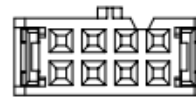
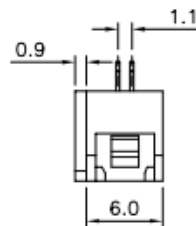
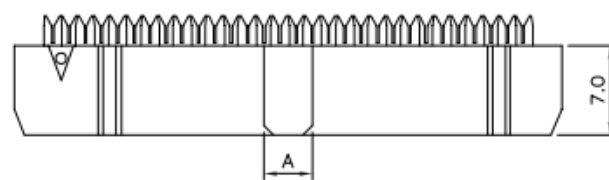
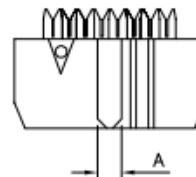

8P
Single Slot

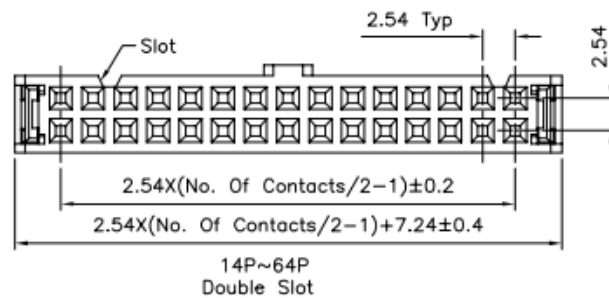
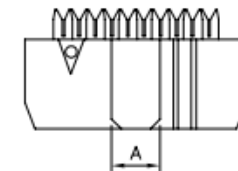

Pin	A
06~08	1.9
10~64	3.8

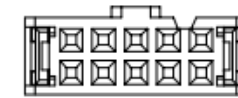

10P~12P
Single Slot

DRAWING No.		APPROVED BY		UNLESS OTHERWISE SPECIFIED TOLERANCES ARE					
15695		MEI				X.* ±3.0'			
		CHECKED BY				.X ±0.15		.X' ±2.0'	
		HZF		.XX ±0.08		.XX' ±1.0'			
		DRAWING BY		.XXX ±0.5'					
		SONG		UNIT		AO NEW RELEASE			
SCALE		NONE		mm		HZF 06/10/2012			
REV.		AO		NO.REV.		REVISIONS			
						CHK DATE			